

ROAD 1
 Hz SCALE 1:500
 Vt SCALE 1:100

ROAD 2
 Hz SCALE 1:500
 Vt SCALE 1:100

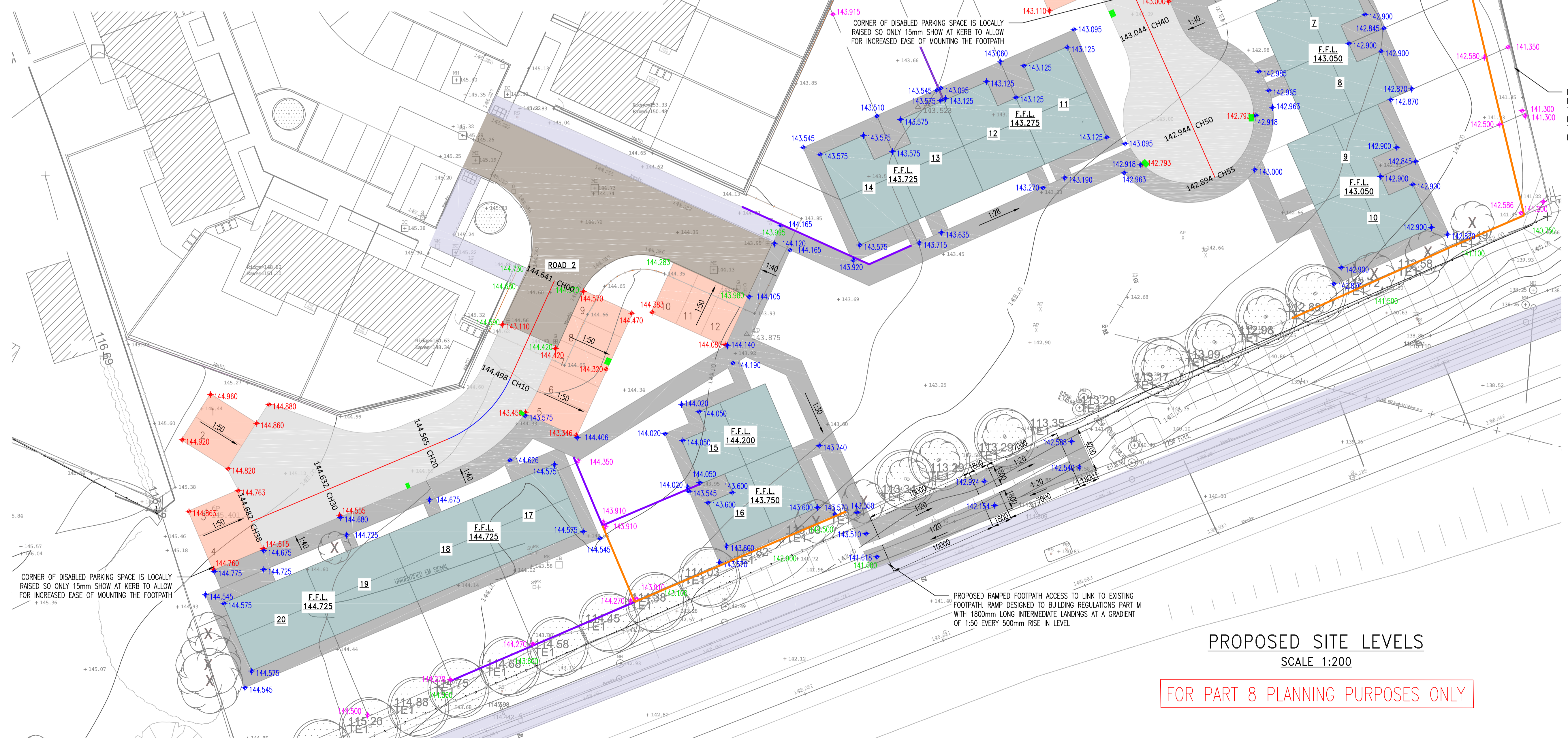

GENERAL NOTES:

- ALL DIMENSIONS AND LEVELS TO BE VERIFIED ON SITE PRIOR TO COMMENCEMENT OF THE WORKS. ANY DISCREPANCIES TO BE REPORTED TO THE ENGINEER.
- THIS DRAWING IS TO BE READ IN CONJUNCTION WITH THE RELEVANT ARCHITECT'S AND OTHER CIVIL ENGINEERING DRAWINGS.

SITE LEVELS LEGEND

70.000	20.434	ROAD CHAINAGE & LEVEL
—	—	HORIZONTAL / VERTICAL CURVATURE
—	—	EXISTING GROUND PROFILE
—	—	PROPOSED GROUND PROFILE
+ 10.00	+	EXISTING ROAD LEVEL
+ 10.00	+	PROPOSED ROAD LEVEL
+ 10.00	+	PROPOSED FOOTPATH LEVEL
+ 10.00	+	PROPOSED GARDEN LEVEL
—	—	PROPOSED SURFACE GRADIENT
—	—	PROPOSED RETAINING WALL > 0.55m
—	—	PROPOSED RETAINING WALL < 0.55m

- NOTES:**
- ALL GARDEN LEVELS WITHIN CURTILAGE OF DWELLING GRADED AT MAX 1:25 (4%)
 - PRIVATE FOOTWAY AROUND DWELLING; NOMINAL 150MM BELOW GROUND FLOOR OF DWELLING SERVED
 - FOOTPATHS AROUND HOUSING BLOCK TO BE GRADED AT 1:40 AWAY FROM BUILDINGS
 - ACCESS FROM PUBLIC FOOTWAY TO GROUND FLOOR OF DWELLING TO COMPLY WITH BUILDING REGULATIONS PART M 1:20 (5%); AS A MAXIMUM
 - PUBLIC FOOTWAY CROSSFALL 1:40 (2.5%)

EXISTING RETAINING WALL APPROXIMATELY 1500-2000mm IN HEIGHT ALONG THIS BOUNDARY. GARDEN LEVELS NEED TO BE KEPT AS EXISTING IN ORDER TO NOT INCREASE LOADING ON THIS EXISTING RETAINING FEATURE. THEREFORE UNITS 5-10 WILL REQUIRE A RETAINING WALL BEHIND UNITS TO ACCOMMODATE THIS.

PROPOSED SITE LEVELS
 SCALE 1:200

FOR PART 8 PLANNING PURPOSES ONLY

DRAWING STATUS:		PART 8 PLANNING	
CLIENT:			
WICKLOW COUNTY COUNCIL			
JOB DESCRIPTION:			
PROPOSED 20 UNIT HD AT AVONDALE HEIGHTS PHASE II, COUNTY WICKLOW.			
DRAWING TITLE:			
PROPOSED SITE LEVELS			
PROJECT No.:	P-3270	DRAWING No.:	C-03
SCALE:	1:200	SHEET:	A1
DATE:	12.02.19	REV. No.:	A
DRAWN BY:	OS	CHECKED BY:	MK
APPROVED BY:	PMCM		

McMahon Associates
 Consulting Civil & Structural Engineers, Project Managers
 Environmental Engineers, CDM Principal Designer & Traffic Engineers

The Mill Building, Newtown Link Rd,
 Greenhills, Drogheda, Co. Louth
 t: +353 (0)41 2137050
 e: info@mcMahonengineers.com